

CONTEG

OUTDOOR CABINETS

The best solution for all outdoor applications



outTEG OMR

Double-walled Free-standing Outdoor Cabinets

WE ARE CONTEG

Leading Producer of **IT, Data Center and Industrial Solutions**

We provide global sales and technical support and have manufacturing plants in Europe—Czech Republic—equipped with the latest technologies, and our testing laboratory.

Our outdoor cabinets in four design series withstand even the most demanding climate conditions thanks to first-class functional properties, mechanical resistance, and long service life. For all types of outdoor cabinets, we offer environmental monitoring, as well as ventilation, cooling, and heating units, which provide a favorable and stable indoor climate.

We are flexible and ready to supply specific solutions according to customers' requirements.



Complex solutions

cabinets, cooling, heating, ventilation, environmental monitoring



User friendly

adapted for flexible and easy installation of all components inside the cabinet



Comprehensive portfolio

free-standing, wall-mount, and pole-mount cabinets made of aluminum and stainless steel



Rigid, resistant

quality materials, up to IP rating 66, double/single-wall construction



Variable

for all types of applications and installations, including in-row installation



Customized solutions

specific solutions according to customer's requirements

outTEG OMR

Double-walled Free-standing Outdoor Cabinets



Suitable for projects where there are strict requirements for a stable internal climate
Aluminum/Stainless Steel
Polyester powder coat with UV protection
PUR non-porous gasket—suitable for extreme temperature range

MAIN ADVANTAGES

- The double-walled construction keeps the internal temperature up to 10 % lower than single-walled cabinets providing additional protection against vandals.
- Possible to assemble into a row
- Highest protection against corrosion
- IP66 dust and water protection
- Cabinets include a plinth and roof
- Welded stainless steel cabinet frame and plinth
- All removable parts are made of aluminum AlMg3 (door, rear/side panels, roof)
- Wide range of system accessories
- Earthquake zone rating (Bellcore)

Application	free-standing, in-row installation
Material	aluminum (body, roof) stainless steel (frame, plinth)
Construction	double-walled
IP rating	IP66
Mechanical protection	IK10
Color	RAL 7035 (body) RAL 7046 (roof and plinth)
Surface finish	polyester powder coating with UV protection
Height	600, 800, 1 000, 1 200, 1 400, 1 600 mm
Width	650, 800, 1 000 mm
Depth	400, 500, 600, 700, 800, 1 000 mm

Cooling	cooling units (0.29–4 kW) thermoelectric coolers (0.1–0.8 kW) ventilation units (0.5–1.1 kW)
---------	--

Heating	heaters
---------	---------

Monitoring	RAMOS Plus monitoring system
------------	------------------------------

Online Configurator	www.conteg.com/configurators
---------------------	--

Modifications	Tailor-made customer solutions—cut-outs according to your requirements before and after final surface finishing
---------------	---



Cooling, Heating & Environmental Monitoring

We calculate and recommend the necessary cooling and heating power to maintain stable thermal comfort for the installed elements inside the outdoor cabinet.

Cooling Units

- Cooling capacity from 0.29 to 4 kW
- IP rating: IP56
- Operating temperature range from $-40\text{ }^{\circ}\text{C}$ up to $+55\text{ }^{\circ}\text{C}$
- Certification: CE, cURus, cULus

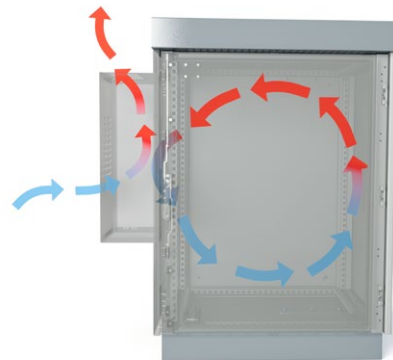

outTEG OMR
+ cooling unit

Thermoelectric Coolers

- Cooling capacity from 0.1 to 0.8 kW
- IP rating: IP66
- Operating temperature range from $-20\text{ }^{\circ}\text{C}$ up to $+65\text{ }^{\circ}\text{C}$

Filter Fans

- Airflow from 12 up to 800 m³/h
- IP rating: IP54
- Operating temperature range from $-10\text{ }^{\circ}\text{C}$ up to $+70\text{ }^{\circ}\text{C}$

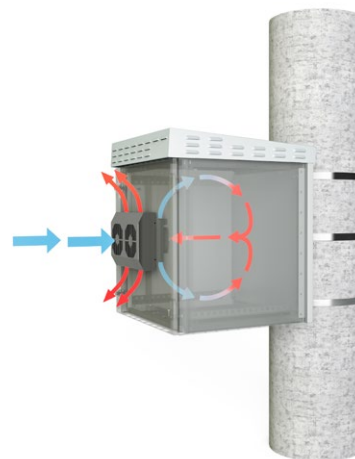

outTEG OMR Lite
+ thermoelectric cooler

Heaters

- Thermal output from 0.25 to 0.8 kW
- IP rating: IP20
- Operating temperature range from $-10\text{ }^{\circ}\text{C}$ up to $+50\text{ }^{\circ}\text{C}$

Environmental Monitoring

- Monitoring system RAMOS Plus comes in two versions: the standard variant and the GSM variant with a built-in GSM modem and an external antenna
- 4 intelligent ports, adjustable as input or output
- Communication: LAN: SNMP v1, v2, and v3; Modbus TCP, GSM: GSM version only
- E-mails or SNMP trap notifications

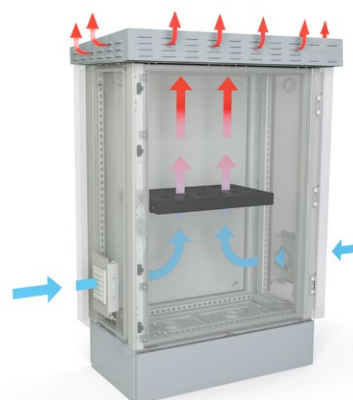

outTEG OMR
+ filter fan